

EOS4 is an important development in the field of optoelectronic safety light curtains.

Innovative features include:

- **Minimal cross section - 28 x 30 mm.**
- **No blind area on one side:**
the position of first beam ensures that the sensitive area extends to end of the light curtain.
- **The solution with two L-mounted light curtains, e.g. Master-Slave, maintains 40 mm resolution in corner** (models with resolution 30 and 40 mm).
- Minimal blind area on connector side.
- Easy connection and installation thanks to the M12 connectors and the use of unshielded cables up to 100 m.
- **Integrated safety functions**, including self-monitoring of static outputs, control of external contactors (EDM) and automatic/manual selectable Restart.
- Exceptional mechanical and electrical robustness are the result of extensive experience gained hands-on with all kinds of applications.
- **Operating temperature range -10 to 55 °C.**
- **Protection rate: IP 65 and IP 67 simultaneously**
High resistance to infiltration by dust and liquids in a highly compact light curtain.
- Models **Master/Slave** for **cascade connection of two or three light curtains.**
- 2 safety PNP static outputs.

EOS4 light curtains may be connected to the dedicated safety interfaces series AD SR, or directly to contactors actuated and controlled by the light curtain, or to safety PLCs or to suitable commercial safety modules.

Special models complying with "Directive ATEX" 94/9/EC - Dust Zone 22 - Gas Zone 2 available on request.

Two L-mounted light curtains maintain 40 mm resolution in the corner (models with resolution 30 and 40 mm)



Cross section

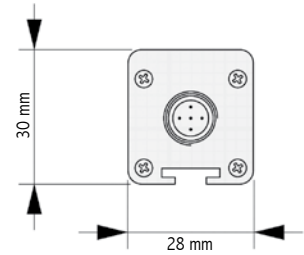

< of safety
light curtain
resolution
=
no blind zone

Safety level: **Type 4 – SIL 3 – SILCL 3 – PL e – Cat. 4**

- 2006/42/CE "Machinery Directive"
- 2004/108/CE "Electromagnetic Compatibility (EMC)"
- 2006/95/CE "Low Voltage Directive (LVD)"
- IEC/EN 61496-1 Ed. 2.1, IEC/TS 61496-2 Ed. 2 "Safety of machinery - Electro-sensitive protective equipment- General requirements and tests"
- EN ISO 13849-1 "Safety of machinery – Safety-related parts of control systems – Part 1: General principles for design"
- IEC/EN 62061 "Safety of machinery – Functional safety of safety-related electrical, electronic and programmable electronic control systems"
- IEC 61508 "Functional safety of electrical/electronic/programmable electronic safety-related systems"
- IEC/TS 62046 Ed. 2 "Safety of machinery – Application of protective equipment to detect the presence of persons"
- UL (C+US) mark for USA and Canada
- ANSI / UL 1998 "Safety Software in Programmable Components".



THE EOS4 RANGE

EOS4 A

- Protected height range 160 to 1510 mm
- 5 types of detection:
 - Resolution 30 - 40 mm for hand detection
 - Resolution 50 - 90 mm for detection of the body in a dangerous area
 - 2 - 3 - 4 beams for detection of the body in access control
- Max. range 12 m
- 2 safety static outputs PNP with auto-test protected against short circuits and overloads
- Automatic Start/Restart
- M12 5-pole connectors.

The ideal light curtain for straightforward interfacing with safety modules or safety PLCs.

EOS4 X

- Protected height range 160 to 1510 mm
- 5 types of detection:
 - Resolution 30 - 40 mm for hand detection
 - Resolution 50 - 90 mm for detection of the body in a dangerous area
 - 2 - 3 - 4 beams for detection of the body in access control
- Max. range 12 m
- M12 5-pole connector for emitter and M12 8-pole for receiver
- Integrated, selectable manual or automatic Start/Restart
- Feedback input for external relay monitoring (EDM)
- Master and Slave models for series connection of two or three light curtains regardless of height or resolution.

An effective light curtain for directly controlling and monitoring machine circuits with no need of external safety modules. Master/Slave models are also ideal for series connection of several light curtains and combined detection of hand and body or the protection of two different sides of a machine.

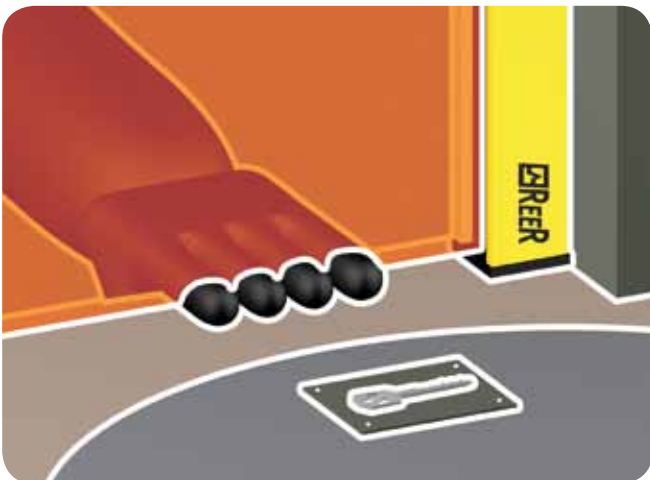

The protected area extends until the light curtain end maintaining the resolution



The resolution is maintained (up to 40 mm) in the junction between the 2 protected areas

EOS4 A

MAIN FEATURES

Automatic Start/Restart.
Two safety PNP static outputs, auto-controlled.
All connections and configurations through M12 5-pole connectors.
Unshielded cables up to 100 meter long.
Start/Restart interlock and EDM through external AD SR1 interface.
Muting function through external AD SRM interface.

TECHNICAL FEATURES

| | |
|--|--|
| Safety level | Type 4 according to IEC/TS 61496-2 SIL 3 – SILCL 3 according to IEC 61508 - IEC 62061 PL e – Cat. 4 according to ISO 13849-1 |
| Protected heights (mm) | 160 ÷ 1510 |
| Resolutions (mm) | 30 – 40 – 50 – 90 |
| Numbers of beams for body detection in access control | 2 – 3 – 4 |
| Max. range (m) | 4 – 12 selectable |
| Response time (ms) | 2,5 ÷ 18,5 |
| Safety outputs | 2 PNP – 400 mA at 24 Vdc |
| Singnaling | LEDs for light curtain's status and diagnostic |
| Start/Restart | automatic |
| Power supply (Vdc) | 24 ± 20% |
| Electrical connections | M12 - 5 poles |
| Max. cable lenght (m) | 100 |
| Operating temperature (°C) | -10 ÷ 55 |
| Protection rating | IP 65 and IP 67 |
| Fastening modes | back slot |
| Cross section (mm) | 28 x 30 |



Safety level:

Type 4

SIL 3 – SILCL 3
PL e – Cat. 4

EOS4 A



| Resolution 30 mm | EOS4 153 A | EOS4 303 A | EOS4 453 A | EOS4 603 A | EOS4 753 A | EOS4 903 A | EOS4 1053 A | EOS4 1203 A | EOS4 1353 A | EOS4 1503 A |
|-------------------------|-----------------------|-----------------------|-----------------------|-----------------------|-----------------------|-----------------------|------------------------|------------------------|------------------------|------------------------|
| Protected heights (mm) | 160 | 310 | 460 | 610 | 760 | 910 | 1060 | 1210 | 1360 | 1510 |
| Number of beams | 8 | 16 | 23 | 31 | 38 | 46 | 53 | 61 | 68 | 76 |
| Overall height (mm) | 213 | 363 | 513 | 663 | 813 | 963 | 1113 | 1263 | 1413 | 1563 |



| Resolution 40 mm | EOS4 154 A | EOS4 304 A | EOS4 454 A | EOS4 604 A | EOS4 754 A | EOS4 904 A | EOS4 1054 A | EOS4 1204 A | EOS4 1354 A | EOS4 1504 A |
|-------------------------|-----------------------|-----------------------|-----------------------|-----------------------|-----------------------|-----------------------|------------------------|------------------------|------------------------|------------------------|
| Protected heights (mm) | 160 | 310 | 460 | 610 | 760 | 910 | 1060 | 1210 | 1360 | 1510 |
| Number of beams | 6 | 11 | 16 | 21 | 26 | 31 | 36 | 41 | 46 | 51 |
| Overall height (mm) | 213 | 363 | 513 | 663 | 813 | 963 | 1113 | 1263 | 1413 | 1563 |



| Resolution 50 mm | EOS4 155 A | EOS4 305 A | EOS4 455 A | EOS4 605 A | EOS4 755 A | EOS4 905 A | EOS4 1055 A | EOS4 1205 A | EOS4 1355 A | EOS4 1505 A |
|-------------------------|-----------------------|-----------------------|-----------------------|-----------------------|-----------------------|-----------------------|------------------------|------------------------|------------------------|------------------------|
| Protected heights (mm) | 160 | 310 | 460 | 610 | 760 | 910 | 1060 | 1210 | 1360 | 1510 |
| Number of beams | 4 | 8 | 12 | 16 | 20 | 24 | 28 | 32 | 36 | 40 |
| Overall height (mm) | 213 | 363 | 513 | 663 | 813 | 963 | 1113 | 1263 | 1413 | 1563 |



| Resolution 90 mm | EOS4 309 A | EOS4 459 A | EOS4 609 A | EOS4 759 A | EOS4 909 A | EOS4 1059 A | EOS4 1209 A | EOS4 1359 A | EOS4 1509 A |
|-------------------------|-----------------------|-----------------------|-----------------------|-----------------------|-----------------------|------------------------|------------------------|------------------------|------------------------|
| Protected heights (mm) | 310 | 460 | 610 | 760 | 910 | 1060 | 1210 | 1360 | 1510 |
| Number of beams | 4 | 6 | 8 | 10 | 12 | 14 | 16 | 18 | 20 |
| Overall height (mm) | 363 | 513 | 663 | 813 | 963 | 1113 | 1263 | 1413 | 1563 |



| 2-3-4-beams | EOS4 2B A | EOS4 3B A | EOS4 4B A |
|------------------------|----------------------|----------------------|----------------------|
| Number of beams | 2 | 3 | 4 |
| Beam spacing (mm) | 500 | 400 | 300 |
| Protected heights (mm) | 510 | 810 | 910 |
| Overall height (mm) | 653 | 953 | 1053 |

• For accessories see page 64 • For ordering codes see page 186

EOS4 X

WITH BUILT-IN CONTROL FUNCTIONS

MAIN FEATURES

Built-in, selectable manual/automatic Start/Restart
Feedback input for controlling external relays (EDM).
Two safety PNP static outputs, auto-controlled.
All connections and setting adjustments through M12 5-pole and 8-pole connectors.
Unshielded cables up to 100 meter long.
Master and Slave models for series connection of up to 3 light curtains.
Max. length of connections toward Slaves: 50 meters, through standard unshielded cable.

TECHNICAL FEATURES

| | |
|--|--|
| Safety level | Type 4 according to IEC/TS 61496-2 SIL 3 – SILCL 3 according to IEC 61508 - IEC 62061 PL e – Cat. 4 according to ISO 13849-1 |
| Protected heights (mm) | 160 ÷ 1510 |
| Resolutions (mm) | 30 – 40 – 50 – 90 |
| Numbers of beams for body detection in access control | 2 – 3 – 4 |
| Max. range (m) | 4 – 12 selectable |
| Response time (ms) | 2,5 ÷ 18,5 |
| Safety outputs | 2 PNP – 400 mA at 24 Vdc |
| Singnaling | LEDs for light curtain's status and diagnostic |
| Start/Restart | selectable automatic or manual |
| External Device Monitoring | external device monitoring feedback input with selectable enabling |
| Power supply (Vdc) | 24 ± 20% |
| Electrical connections for EOS4 X and EOS4 X Master | M12 - 5 poles for emitter M12 - 8 poles for receiver |
| Electrical connections between Master and Slave | M12 - 5 poles for emitter and receiver |
| Max. cable lenght (m) | 100 (50 between Master and Slave) |
| Operating temperature (°C) | -10 ÷ 55 |
| Protection rating | IP 65 and IP 67 |
| Fastening modes | back slot |
| Cross section (mm) | 28 x 30 |

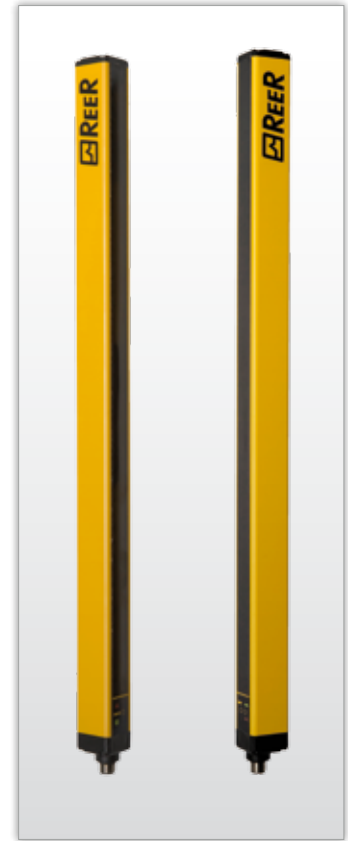

Safety level:

Type 4

SIL 3 – SILCL 3
PL e – Cat. 4



EOS4 X

WITH BUILT-IN CONTROL FUNCTIONS



| Resolution 30 mm | EOS4 153 X | EOS4 303 X | EOS4 453 X | EOS4 603 X | EOS4 753 X | EOS4 903 X | EOS4 1053 X | EOS4 1203 X | EOS4 1353 X | EOS4 1503 X |
|-------------------------|-----------------------|-----------------------|-----------------------|-----------------------|-----------------------|-----------------------|------------------------|------------------------|------------------------|------------------------|
| Protected heights (mm) | 160 | 310 | 460 | 610 | 760 | 910 | 1060 | 1210 | 1360 | 1510 |
| Number of beams | 8 | 16 | 23 | 31 | 38 | 46 | 53 | 61 | 68 | 76 |
| Overall height (mm) | 213 | 363 | 513 | 663 | 813 | 963 | 1113 | 1263 | 1413 | 1563 |



| Resolution 40 mm | EOS4 154 X | EOS4 304 X | EOS4 454 X | EOS4 604 X | EOS4 754 X | EOS4 904 X | EOS4 1054 X | EOS4 1204 X | EOS4 1354 X | EOS4 1504 X |
|-------------------------|-----------------------|-----------------------|-----------------------|-----------------------|-----------------------|-----------------------|------------------------|------------------------|------------------------|------------------------|
| Protected heights (mm) | 160 | 310 | 460 | 610 | 760 | 910 | 1060 | 1210 | 1360 | 1510 |
| Number of beams | 6 | 11 | 16 | 21 | 26 | 31 | 36 | 41 | 46 | 51 |
| Overall height (mm) | 213 | 363 | 513 | 663 | 813 | 963 | 1113 | 1263 | 1413 | 1563 |



| Resolution 50 mm | EOS4 155 X | EOS4 305 X | EOS4 455 X | EOS4 605 X | EOS4 755 X | EOS4 905 X | EOS4 1055 X | EOS4 1205 X | EOS4 1355 X | EOS4 1505 X |
|-------------------------|-----------------------|-----------------------|-----------------------|-----------------------|-----------------------|-----------------------|------------------------|------------------------|------------------------|------------------------|
| Protected heights (mm) | 160 | 310 | 460 | 610 | 760 | 910 | 1060 | 1210 | 1360 | 1510 |
| Number of beams | 4 | 8 | 12 | 16 | 20 | 24 | 28 | 32 | 36 | 40 |
| Overall height (mm) | 213 | 363 | 513 | 663 | 813 | 963 | 1113 | 1263 | 1413 | 1563 |



| Resolution 90 mm | EOS4 309 X | EOS4 459 X | EOS4 609 X | EOS4 759 X | EOS4 909 X | EOS4 1059 X | EOS4 1209 X | EOS4 1359 X | EOS4 1509 X |
|-------------------------|-----------------------|-----------------------|-----------------------|-----------------------|-----------------------|------------------------|------------------------|------------------------|------------------------|
| Protected heights (mm) | 310 | 460 | 610 | 760 | 910 | 1060 | 1210 | 1360 | 1510 |
| Number of beams | 4 | 6 | 8 | 10 | 12 | 14 | 16 | 18 | 20 |
| Overall height (mm) | 363 | 513 | 663 | 813 | 963 | 1113 | 1263 | 1413 | 1563 |



| 2-3-4-beams | EOS4 2B X | EOS4 3B X | EOS4 4B X |
|------------------------|----------------------|----------------------|----------------------|
| Number of beams | 2 | 3 | 4 |
| Beam spacing (mm) | 500 | 400 | 300 |
| Protected heights (mm) | 510 | 810 | 910 |
| Overall height (mm) | 653 | 953 | 1053 |

• For accessories see page 64 • For ordering codes see page 186

EOS4 X

WITH BUILT-IN CONTROL FUNCTIONS

MASTER/SLAVE MODELS



| MASTER Resolution 30 mm | | EOS4 303 XM | EOS4 453 XM | EOS4 603 XM | EOS4 753 XM | EOS4 903 XM | EOS4 1053 XM | EOS4 1203 XM | EOS4 1353 XM | EOS4 1503 XM |
|-----------------------------|-------------------|--------------------|--------------------|--------------------|--------------------|--------------------|---------------------|---------------------|---------------------|---------------------|
| SLAVE Resolution 30 mm | EOS4 153 XS | EOS4 303 XS | EOS4 453 XS | EOS4 603 XS | EOS4 753 XS | EOS4 903 XS | EOS4 1053 XS | EOS4 1203 XS | EOS4 1353 XS | EOS4 1503 XS |
| SLAVE 2 Resolution 30 mm | | EOS4 303 XS2 | EOS4 453 XS2 | EOS4 603 XS2 | EOS4 753 XS2 | EOS4 903 XS2 | EOS4 1053 XS2 | EOS4 1203 XS2 | EOS4 1353 XS2 | EOS4 1503 XS2 |
| Protected heights (mm) | 160 | 310 | 460 | 610 | 760 | 910 | 1060 | 1210 | 1360 | 1510 |
| Number of beams | 8 | 16 | 23 | 31 | 38 | 46 | 53 | 61 | 68 | 76 |
| Overall height (mm)* | 213 | 363 | 513 | 663 | 813 | 963 | 1113 | 1263 | 1413 | 1563 |



| MASTER Resolution 40 mm | | EOS4 304 XM | EOS4 454 XM | EOS4 604 XM | EOS4 754 XM | EOS4 904 XM | EOS4 104 XM | EOS4 1204 XM | EOS4 1354 XM | EOS4 1504 XM |
|-----------------------------|-------------------|--------------------|--------------------|--------------------|--------------------|--------------------|---------------------|---------------------|---------------------|---------------------|
| SLAVE Resolution 40 mm | EOS4 154 XS | EOS4 304 XS | EOS4 454 XS | EOS4 604 XS | EOS4 754 XS | EOS4 904 XS | EOS4 1054 XS | EOS4 1204 XS | EOS4 1354 XS | EOS4 1504 XS |
| SLAVE 2 Resolution 40 mm | | EOS4 304 XS2 | EOS4 454 XS2 | EOS4 604 XS2 | EOS4 754 XS2 | EOS4 904 XS2 | EOS4 1054 XS2 | EOS4 1204 XS2 | EOS4 1354 XS2 | EOS4 1504 XS2 |
| Protected heights (mm) | 160 | 310 | 460 | 610 | 760 | 910 | 1060 | 1210 | 1360 | 1510 |
| Number of beams | 6 | 11 | 16 | 21 | 26 | 31 | 36 | 41 | 46 | 51 |
| Overall height (mm)* | 213 | 363 | 513 | 663 | 813 | 963 | 1113 | 1263 | 1413 | 1563 |



| MASTER Resolution 50 mm | | EOS4 305 XM | EOS4 455 XM | EOS4 605 XM | EOS4 755 XM | EOS4 905 XM | EOS4 105 XM | EOS4 1205 XM | EOS4 1355 XM | EOS4 1505 XM |
|-----------------------------|-------------------|--------------------|--------------------|--------------------|--------------------|--------------------|---------------------|---------------------|---------------------|---------------------|
| SLAVE Resolution 50 mm | EOS4 155 XS | EOS4 305 XS | EOS4 455 XS | EOS4 605 XS | EOS4 755 XS | EOS4 905 XS | EOS4 1055 XS | EOS4 1205 XS | EOS4 1355 XS | EOS4 1505 XS |
| SLAVE 2 Resolution 50 mm | | EOS4 305 XS2 | EOS4 455 XS2 | EOS4 605 XS2 | EOS4 755 XS2 | EOS4 905 XS2 | EOS4 1055 XS2 | EOS4 1205 XS2 | EOS4 1355 XS2 | EOS4 1505 XS2 |
| Protected heights (mm) | 160 | 310 | 460 | 610 | 760 | 910 | 1060 | 1210 | 1360 | 1510 |
| Number of beams | 4 | 8 | 12 | 16 | 20 | 24 | 28 | 32 | 36 | 40 |
| Overall height (mm)* | 213 | 363 | 513 | 663 | 813 | 963 | 1113 | 1263 | 1413 | 1563 |

EOS4 X

WITH BUILT-IN CONTROL FUNCTIONS



| MASTER Resolution 90 mm | EOS4 309 XM | EOS4 459 XM | EOS4 609 XM | EOS4 759 XM | EOS4 909 XM | EOS4 1059 XM | EOS4 1209 XM | EOS4 1359 XM |
|------------------------------------|-----------------------------|-----------------------------|-----------------------------|-----------------------------|-----------------------------|------------------------------|------------------------------|------------------------------|
| SLAVE Resolution 90 mm | EOS4 309 XS | EOS4 459 XS | EOS4 609 XS | EOS4 759 XS | EOS4 909 XS | EOS4 1059 XS | EOS4 1209 XS | EOS4 1359 XS |
| SLAVE 2 Resolution 90 mm | EOS4 309 XS2 | EOS4 459 XS2 | EOS4 609 XS2 | EOS4 759 XS2 | EOS4 909 XS2 | EOS4 1059 XS2 | EOS4 1209 XS2 | EOS4 1359 XS2 |
| Protected heights (mm) | 310 | 460 | 610 | 760 | 910 | 1060 | 1210 | 1360 |
| Number of beams | 4 | 6 | 8 | 10 | 12 | 14 | 16 | 18 |
| Overall height (mm) * | 363 | 513 | 663 | 813 | 963 | 1113 | 1263 | 1413 |



| MASTER 2-3-4 beams | EOS4 2B XM | | EOS4 3B XM | | EOS4 4B XM | |
|-------------------------------|--------------------|--|--------------------|--|--------------------|--|
| SLAVE 2-3-4 beams | EOS4 2B XS | | EOS4 3B XS | | EOS4 4B XS | |
| SLAVE 2 2-3-4 beams | EOS4 2B XS2 | | EOS4 3B XS2 | | EOS4 4B XS2 | |
| Number of beams | 2 | | 3 | | 4 | |
| Beam spacing (mm) | 500 | | 400 | | 300 | |
| Protected heights (mm) | 510 | | 810 | | 910 | |
| Overall height (mm) * | 653 | | 953 | | 1053 | |

* On master and slave 2 the total height of light curtain is 24 mm greater owing to the addition of a secondary connector

• For accessories see page 64 • For ordering codes see page 186

MASTER/SLAVE MODELS

Master/Slave models permit series connection of up to three light curtains and combined detection of hand and presence of a person or of more sides of the machine, with the following major benefits:

- A single pair of safety outputs
- No interference between light curtains installed adjacent to one another.

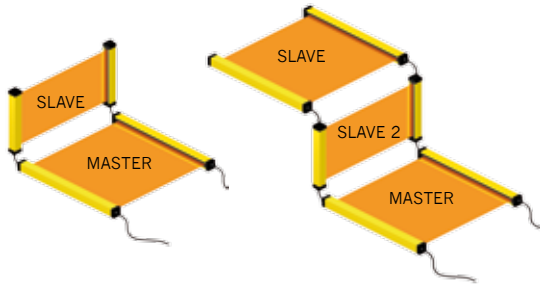

EXAMPLES OF SERIES CONNECTION OF MASTER AND SLAVE LIGHT CURTAINS

Any Master model can be used together with any Slave model.

All electrical connections are made using M12 5-pole connectors, except for Master receivers which necessitate the adoption of M12 8-pole connectors.

Accessory pre-wired cable with twin connectors are available for connection of Master to Slave.

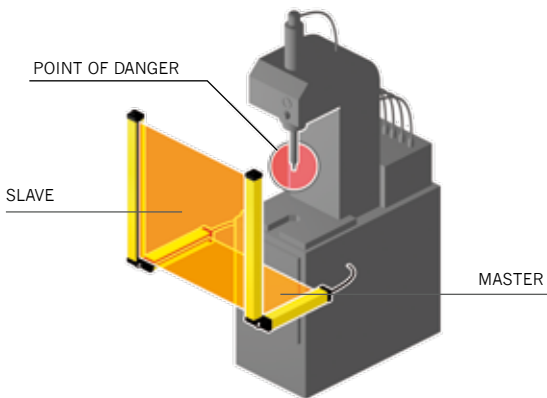

EXAMPLES OF SERIES CONNECTION OF MASTER AND SLAVE LIGHT CURTAINS

Master light curtain is placed horizontally for detection of the person and Slave light curtain is placed vertically to detect fingers or hands.

The arrangement can be reversed to have the Master light curtain vertical for finger and hand detection and the Slave light curtain horizontally for detecting the presence of a person.

The application shown is one of the most common: horizontal curtains are used to prevent the operator from being undetected in the space between vertical light curtain and dangerous machine, upon system start-up or restarting.

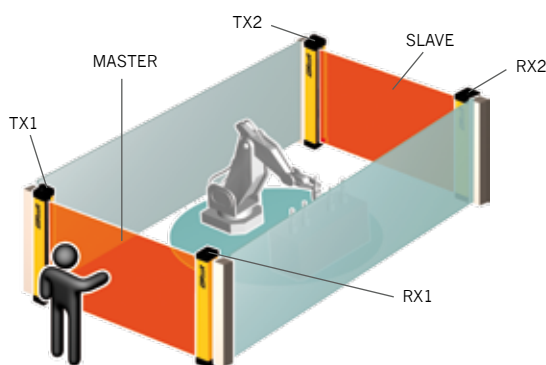

EXAMPLE OF SERIES CONNECTION OF MASTER AND SLAVE LIGHT CURTAINS FOR PROTECTION OF TWO SIDES OF MACHINE

On EOS4 X the connecting cable across Master and Slave is a standard (unshielded) cable up to 50 meter long.

Thus, two series connected curtains may be located one at the front of the machine and the other at the rear, with a single connection to the machine power and control circuitry.



EXAMPLE OF SERIES CONNECTION OF ONE MASTER AND TWO SLAVE LIGHT CURTAINS FOR THE PROTECTION OF THREE SIDES OF THE MACHINE

Benefit: unimpeded operator access to work area from front and sides.

Continues

Follows

Series connections diagram

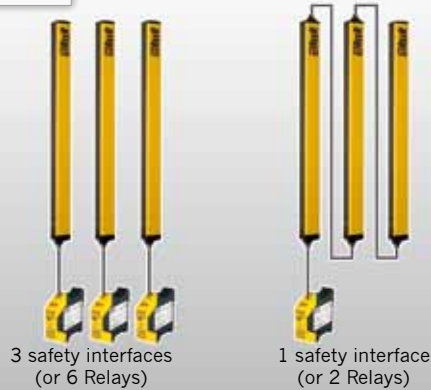

Benefit: with three standard curtains it will be necessary to use and wire up 3 safety interfaces or 6 contactors.

With the master/slave solution having 3 series light curtains it will be enough to use and wire up only 1 safety interface or 2 contactors.

DIMENSIONS (mm)

EOS4 SLAVE

EOS4 MASTER / SLAVE 2

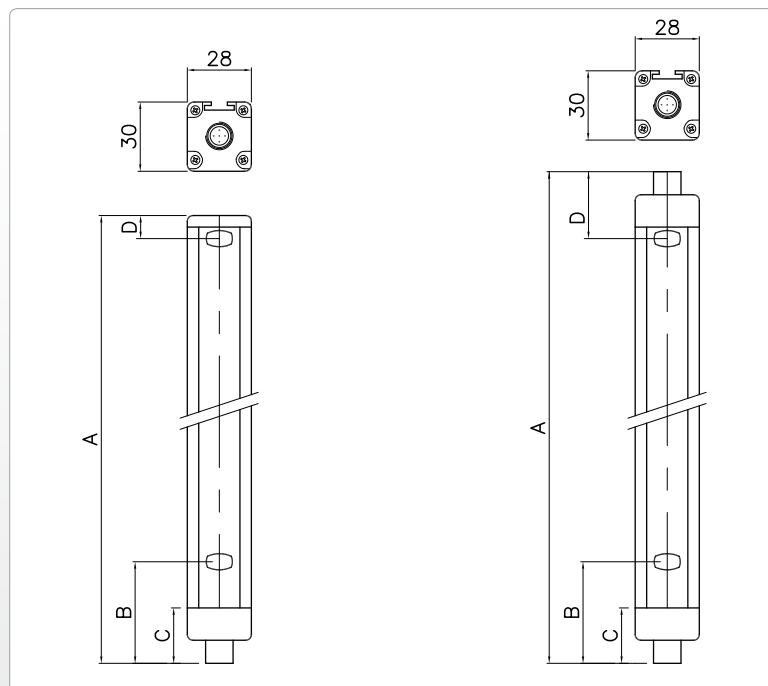

| Model | 2B | 3B | 4B |
|--|------|-----|------|
| A | 653 | 953 | 1053 |
| A (Master/Slave2) | 677 | 977 | 1077 |
| B | 102 | | |
| C | 29.5 | | |
| D | 51 | | |
| D (Master/Slave2) (with 2 connectors) | 75 | | |

| Model | 150 | 300 | 450 | 600 | 750 | 900 | 1050 | 1200 | 1350 | 1500 |
|---|-----------------------------------|-------|-------|-------|-------|-------|--------|-----------------------------------|--------|--------|
| A | 213 | 363 | 513 | 663 | 813 | 963 | 1113 | 1263 | 1413 | 1563 |
| A (Master/Slave) | 236.5 | 386.5 | 536.5 | 686.5 | 836.5 | 986.5 | 1136.5 | 1286.5 | 1436.5 | 1586.5 |
| B | 61.5 | | | | | | | | | |
| C | 29.5 | | | | | | | | | |
| D | 11 | | | | | | | | | |
| D (Master/Slave 2) (with 2 connectors) | 34.5 | | | | | | | | | |
| Mounting | 2 LE type brackets with 2 inserts | | | | | | | 3 LE type brackets with 3 inserts | | |

EOS4

ORDERING INFORMATION (for ordering codes see page 186)

Each EOS4 light curtain comprises:

- Emitter and Receiver pair
- Brackets and inserts
- CD-ROM containing the multi-language instruction manual complete with CE declaration of conformity
- Quick installation guide

ACCESSORIES

EOS4 light curtains can be supplied with the following accessories, to be ordered separately:

- AD SR Safety Relays see page 158
- LAD laser alignment device see page 182
- FMC floor mounting columns see page 178
- SP deflection mirrors see page 181
- SAV E vibrations dampers see page 183
- SFB swivel fixing brackets see page 183
- Connectors see list hereunder:

CONNECTORS EOS4 (EOS4 A emitter and receiver EOS4 X emitter)

| Model | Description |
|--------|--|
| CD 5 | M12 straight connector, 5 poles, pre-wired cable 5 m |
| CD 10 | M12 straight connector, 5 poles, pre-wired cable 10 m |
| CD 15 | M12 straight connector, 5 poles, pre-wired cable 15 m |
| CD 20 | M12 straight connector, 5 poles, pre-wired cable 20 m |
| CD 25 | M12 straight connector, 5 poles, pre-wired cable 25 m |
| CD 95 | M12 90° angle connector, 5 poles, pre-wired cable 5 m |
| CD 910 | M12 90° angle connector, 5 poles, pre-wired cable 10 m |
| CD 915 | M12 90° angle connector, 5 poles, pre-wired cable 15 m |
| CDM 9 | M12 straight connector, 5 poles with screw terminal, PG9 cable gland |
| CDM 99 | M12 angle connector, 5 poles with screw terminal, PG9 cable gland |

CONNECTORS EOS4 X receivers

| Model | Description |
|----------|--|
| C8D 5 | M12 straight connector, 8 poles, pre-wired cable 5 m |
| C8D 10 | M12 straight connector, 8 poles, pre-wired cable 10 m |
| C8D 15 | M12 straight connector, 8 poles, pre-wired cable 15 m |
| C8D 95 | M12 90° angle connector, 8 poles, pre-wired cable 5 m |
| C8D 910 | M12 90° angle connector, 8 poles, pre-wired cable 10 m |
| C8D 915 | M12 90° angle connector, 8 poles, pre-wired cable 15 m |
| C8DM 11 | M12 straight connector, 8 poles with screw terminal, PG9/11 cable gland |
| C8DM 911 | M12 90° angle connector, 8 poles with screw terminal, PG9/11 cable gland |

CONNECTION BETWEEN MASTER AND SLAVE

| Model | Description |
|---------|---|
| CDS 03 | 0,3 m pre-wired cable with 2 straight connectors, M12 5 poles |
| CIBE 3 | 3 m pre-wired cable with 2 straight connectors, M12 5 poles |
| CIBE 5 | 5 m pre-wired cable with 2 straight connectors, M12 5 poles |
| CIBE 10 | 10 m pre-wired cable with 2 straight connectors, M12 5 poles |



WARNING !

- Where the light curtain is subjected to strong vibrations (presses, textile looms, etc.) always use vibrations dampers SAV E (available as accessories) in order to prevent damaging the light curtain
- Where protections are to be placed over long distances or on several sides using deflection mirrors, it is advisable to use laser alignment aid LAD 4 to ensure simple, quick and perfect alignment of light curtains.

ADMIRAL

